

Malcolm Wager
108 Jubilee Road
Carters Ridge
Qld 4563
Ph 07 5447 9441

02/04/2007

Dear Sir/Madam,

RE: Inquiry into Additional Water Supplies for South East Queensland – Traveston Crossing Dam Information.

I would like the committee to be aware of the great injustice the people of the Mary Valley have been dealt and the direct impact this proposed dam at Traveston crossing has had on my family, the neglect we have felt from the company handling the building of the proposed dam. I would also like answers to questions which appear to have been consistently ignored by Queensland Water and Infrastructure and the Queensland government.

My wife and my mother in law moved to Carters Ridge 3 1/2 years ago. Our community was all new as most of us at Jubilee Road have also recently moved in. When we purchased the property which was a bed and breakfast, there was no indication of any proposed dam in the area. When the announcement came in April 2006 we were devastated. As details became available, it was apparent that some of our street was going to be affected. As time progressed, it became apparent that the first 90m or so of Jubilee Road would be affected by stage two of the proposed dam if it were built. As I mentioned earlier we were all new to the area and had built up a great little community where most people knew each other and everyone got on well. As time progressed and more information became available, it was clear that those who were directly affected, those at the start of Jubilee Road, had the option to sell to the government. They each received paperwork from the government advising them of what was happening and options available. Those of us just outside this barrier received no information what so ever. We were kept in the dark. As the stress of the dam became too great for some, our community began to crumble. People began to sell to the government and move out of the area. Whilst we have not lost contact with some of our neighbours the stress has been overwhelming to us all, especially my mother in law, Anita Connelly. It was a regular visit to her local GP that signs of stress were detected and as such the GP sent Anita for tests. Please find a copy of the letter from the GP attached. As a result I approached a local real estate agent to see what my prospects of selling my property were. In a nut shell they were very slim. I have also attached a copy of his brief report. As a last resort I sent two letters to the head of QWI asking if the company would purchase our property on compassionate grounds. Please find a copy of their reply. As a result I am trapped in a property I cannot sell and my 81 year old mother in law has been prescribed anti depressants of which she is refusing to take. It is a disgrace that this government can destroy communities and peoples lives on an ad hoc plan which appears to have had no thorough planning or appropriate consultation.

My wife and I have attended most of the meetings brought about by this proposed dam as we look for answers or possible solutions to our problem. There are three questions that I feel needed to be answered and I trust the said committee will do the right thing by the people of Queensland and specifically the Mary Valley.

1. What planning had the Queensland government undertaken prior to the announcement in April 2006? Why has this information been kept from the people of Queensland? What made the selection of this site better than any other options, was it cost, location, it definitely wasn't the best site for a dam. Scientific evidence has shown that a shallow dam (less than 5m average depth) is prone to high evaporation, infestation of water borne weeds such as the water hyacinth and the severe possibilities of green algae which would make the water unusable.
2. Late last year a local grazier, Ron McMahon, identified a better site at the location of Borumba Dam. The raising of the wall at Borumba dam was always on the agenda however Mr. McMahon identified that an even bigger wall, with far more potential capacity was achievable due to the granite composition of the surrounding walls. I believe this was investigated by private engineers but the QWI seems to want to ignore this proposal for reasons unknown. As some stage the premier and assistant premier have met with Mr. McMahon but the issue of legal paperwork seems to have stopped this in its tracks. The government already owns that land that would be required for the extension to Bourumba dam. This would not require anyone to be displaced, 5000 homes could be saved. There is already infrastructure in place to assist with construction and the yield would be ample to support the other alternatives (recycling, desalination and reusable energy) Why has this not been investigated further?
3. This country is in the grip of the worst drought on record. You need rain to fill a dam and with no rain there will be no dam. The data the government has used is out dated and unreliable. 100 years ago there was more rain but those levels of rain have not been seen for many years and may never be seen again. The world's scientific community is opposed to dams. There is a massive amount of literature available on the web that shows how destructive they are to our environmental, economic and social community. We have the possibility of losing three high profile endangered species in the lung fish, the Mary River Cod and the Mary River turtle to name just a few. These could be lost forever if this dam goes ahead. The previous disaster at Paradise dam has a very poor rating from the scientific community and for the government to use this as a yard stick is outrageous. I believe there is a document that proves their attempt to save the turtles was a failure but this report has been kept hidden, for now. The government has also indicated that they want to conduct an EIS only on stage one of the proposed dam but wish to build the dam wall to the full height of stage two. This EIS must be done to cover stages one and two if the dam wall is to be built to its full height as the start. An independent report by the council of Mayor was scoffed upon by our government which simply shows that they are not prepared to listen to anyone who has constructive, reliable information as to how we can save our country.

I am convinced that there is a hidden agenda and this government will continue to keep the truth from the people for as long as it can. The proposed dam will not be finished until well after Brisbane has run out of water. The water grid may delay this possibility but the facts are there, we need to look at alternative.

I trust the committee will do all in its power to ensure that all the information requested will be made available and the government will be held accountable for their actions. We must make the government look closer at the alternatives and work with the scientific community to solve our countries water crisis. I have lived on tank water for the last 3 years and have managed my supply by careful usage and taking the necessary preventative steps. If we all do this then there would be no need for more dams, anywhere in Australia.

Sincerely,

A handwritten signature in black ink, appearing to read 'Mal Wager', with a long horizontal flourish extending to the right.

Mal Wager



DR. LEON VENTER
M.B.Ch.B(Pret.), FACRRM, FRACGP
GENERAL PRACTITIONER
PROVIDER NO: 2152807H

MAPLE STREET SURGERY
46 MAPLE STREET
COOROY, QLD. 4563

POSTAL ADDRESS:
BOX 2 COOROY,
QLD. 4563

PHONE: (07) 5447 6644
FAX: (07) 5442 6226
E-mail: docmss@bigpond.com

TO WHOM IT MAY CONCERN

24/10/2006

RE: Mrs Anita Sophia Connelly 26/01/1926

Dear Sir / Madam

Mrs Connelly suffers from severe depression following a decision to build the Traveston dam.

This involves her because her property is on the border of the proposed dam area.

She is unable to find a buyer for her property at this stage.

It was hoped that the Queensland Government will give consideration to the purchase of her property for the development of the dam as well.

Yours faithfully

Dr. Leon Venter

COMPARATIVE MARKET ANALYSIS

Prepared on 20 December 2006

CARTERS RIDGE			
----------------------	---	---	---

108 JUBILEE RD, CARTERS RIDGE, QLD 4563

Local Authority: COOLOOLA

UBD: Sunshine Coast - 013 D12

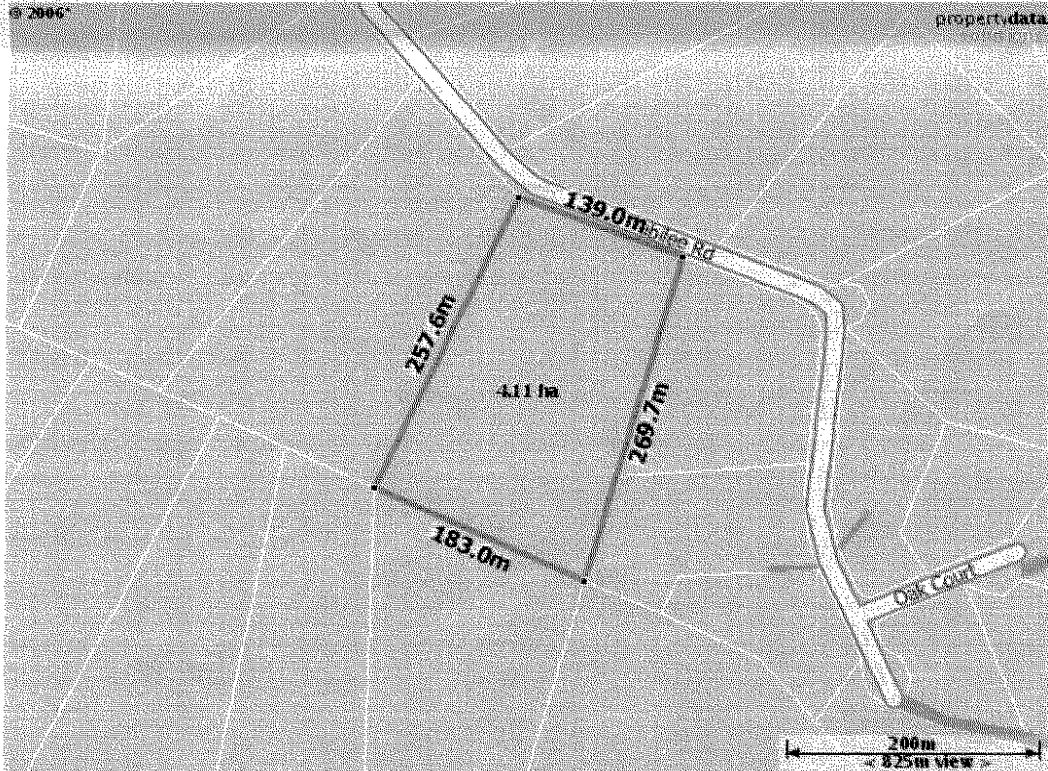

Agent Comments:
 The indecision of Qld Govt in the proposed Traveston Crossing Dam is making any attempt to sell property, including that which is not affected, almost pointless, if not impossible. Until this cloud of uncertainty is lifted, I would not be willing to waste my time on a product which may or may not be for sale, affected (to what degree) or un-affected but still carrying the "stigma" of dis-information over future outcomes.

Property Summary:	
Bedrooms:	
Bathrooms:	
Carparks:	
Land:	4.11 ha
Features:	

This Report prepared for:	
Name:	Malcolm & Pauline Wager
Contact your agent for further information:	
Sales Person:	David Lafferty
Office:	Hintermoosa Realty
Mobile:	0410 445 918
Office Phone:	54477000
Email:	david@hintermoosa.com.au
Office Website:	ww.hintermoosa.com.au





QUEENSLAND WATER
INFRASTRUCTURE PTY LTD

100 Jubilee Road

Carters Ridge QLD 4563
Tel: 1800 133 258
Fax: 07 464 7700

www.qwi.com.au

Date: 29 January 2007

M Wager and AS Connelly
108 Jubilee Road
CARTERS RIDGE QLD 4563

Dear M Wager and AS Connelly

Thank you for your letter dated 10 January 2007, in which you outlined a range of concerns regarding the proposed Traveston Crossing Dam.

Over the past few months, a significant amount of work has been undertaken to determine the final dam boundary and I can now confirm that your property is outside the dam's boundary reservoir and buffer areas.

Queensland Water Infrastructure Pty Ltd (QWI) has carefully reviewed all details of your case, but confirm that as your property is not required for the proposed dam, QWI does not intend to purchase your property. QWI's primary charter is to purchase properties that are required for the proposed Traveston Crossing Dam, as identified on the land purchasing plan released in late October 2006.

Attached for your reference is a map of the dam area, which shows the boundary of the land needed for the project and the proposed alignments for the roads that will be relocated for each stage of the proposed dam.

Please accept my assurance that QWI is committed to behaving with integrity and working with all people in a respectful manner. Should you require further assistance such as counselling or advice regarding financial matters, I recommend you contact the Community Futures Taskforce on 1800 133 258.

Yours sincerely

Graeme Newton
Chief Executive Officer
QUEENSLAND WATER INFRASTRUCTURE PTY LTD