

Locality Plan

Berrimah, Darwin NT



Australian Government
Department of Immigration and
Multicultural and Indigenous Affairs

DARWIN
DETENTION FACILITY

Annexure 1

Site Plan

Berrimah, Darwin NT

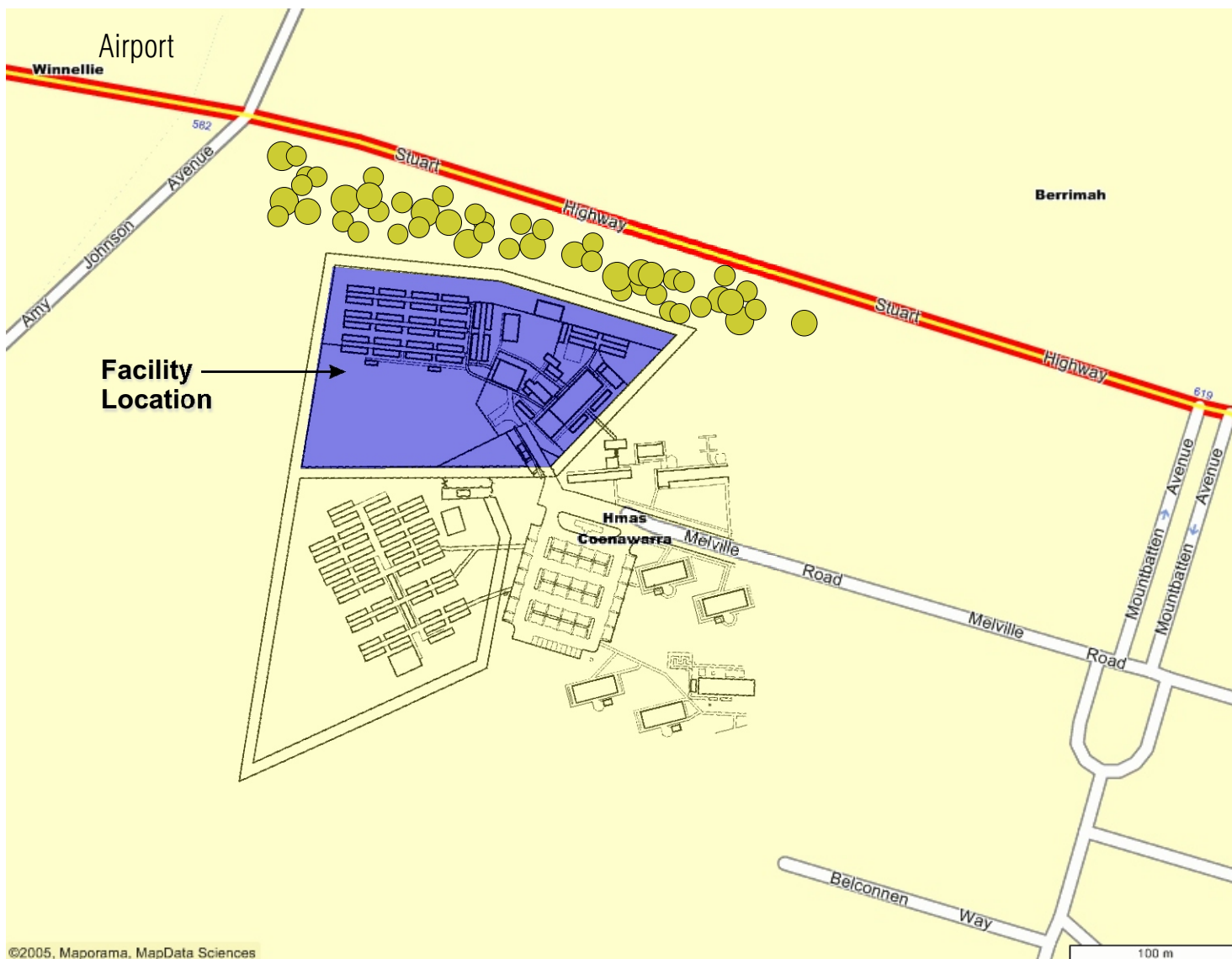

Australian Government
Department of Immigration and
Multicultural and Indigenous Affairs



DARWIN
DETENTION FACILITY

Annexure 2

Building Location Plan

Berrimah, Darwin NT

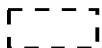
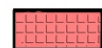



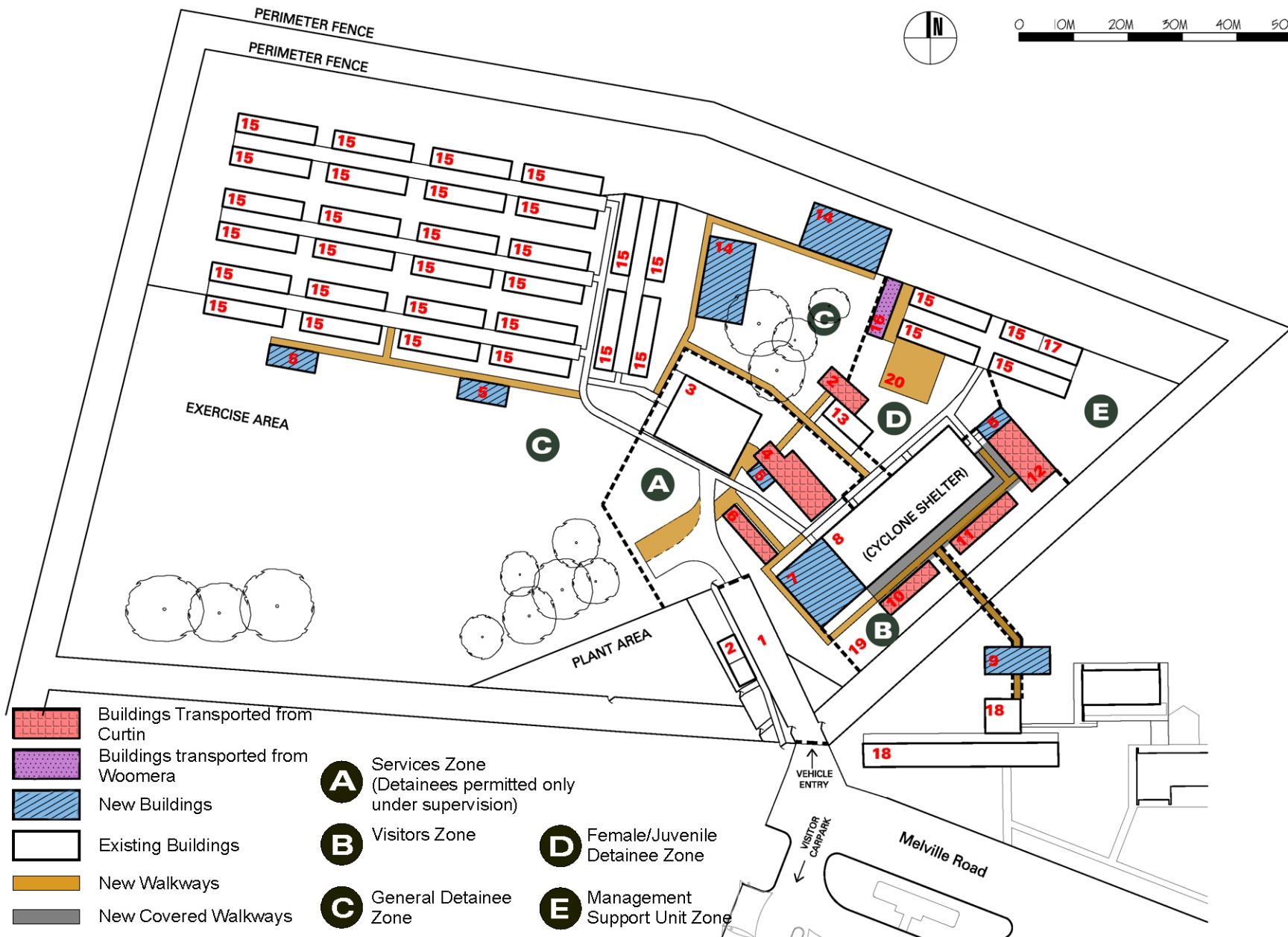

-  New Buildings
-  Existing Buildings
-  Buildings Transported from Curtin
-  Buildings transported from Woomera

Master Plan

Berrimah, Darwin NT

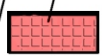

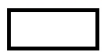
- 1** Vehicle Sally Port
- 2** Officer Station
- 3** Detainee Induction, Processing & Property Store
- 4** Medical Centre
- 5** Ablutions Building
- 6** Dry Goods Store
- 7** Kitchen
- 8** Dining & Recreation Facility (Cyclone Shelter)
- 9** Visitor Reception Processing & Screening
- 10** Visits Centre
- 11** Interview Building
- 12** Detention Services
- 13** Laundry
- 14** Cabana
- 15** Accommodation
- 16** Disabled Accommodation
- 17** Management Unit
- 18** DIMIA Administration
- 19** External Visits Area
- 20** External Shaded Recreation Area

-  Buildings Transported from Curtin
-  Buildings transported from Woomera
-  New Buildings
-  Existing Buildings
-  New Walkways
-  New Covered Walkways

- A** Services Zone (Detainees permitted only under supervision)
- B** Visitors Zone
- C** General Detainee Zone
- D** Female/Juvenile Detainee Zone
- E** Management Support Unit Zone

Site Plan

Berrimah, Darwin NT

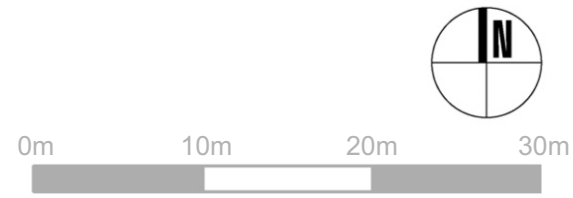

Circulation

- 1** Detainee Arrival
- 2** Detainees are directed to be processed
- 3** If medical attention is required Detainees are sent to the Medical building
- 4** If more serious medical attention is required the Detainee will be transported via ambulance to hospital
- 5** Food Deliveries report to the Stores building
- 6** Refrigerated foods to the kitchen cold storage
- 7** Food Supplies can be readily accessed from the Stores building
- 8** Processing complete
- 9** Routine access for Detainees requiring medical attention

A Services Zone
(Detainees may be permitted in this zone under strict supervision)



Australian Government
Department of Immigration and
Multicultural and Indigenous Affairs

DARWIN
DETENTION FACILITY

Annexure 5

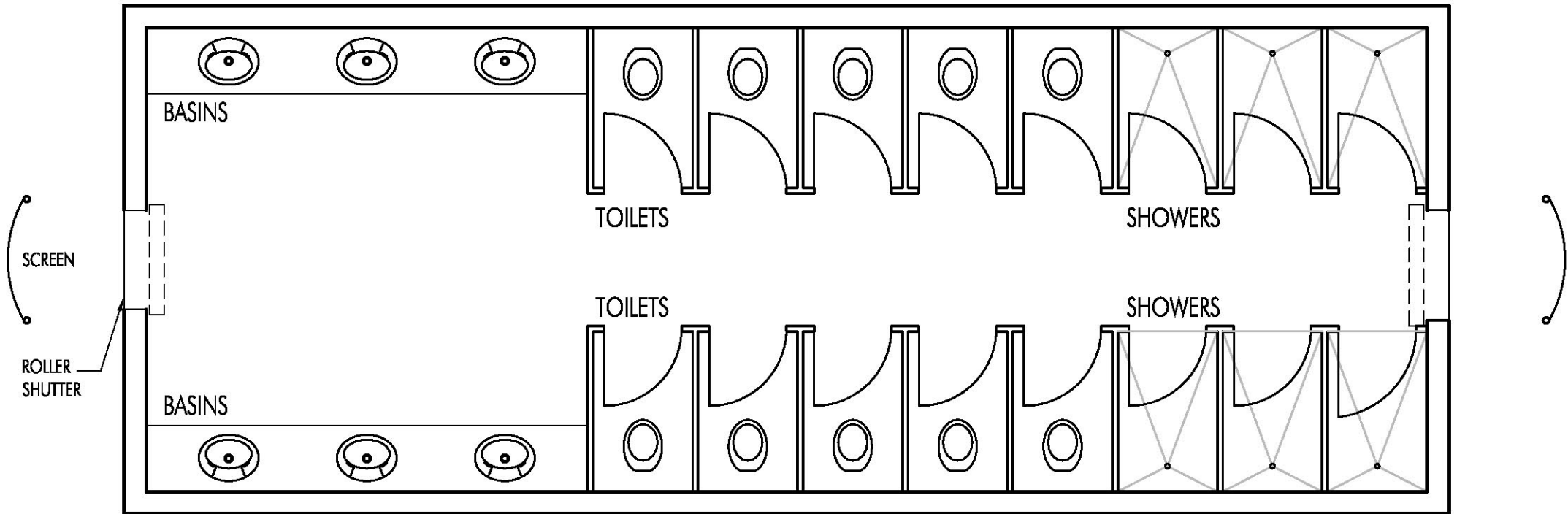

ABLUTIONS BUILDING
Floor Plan - 1:50

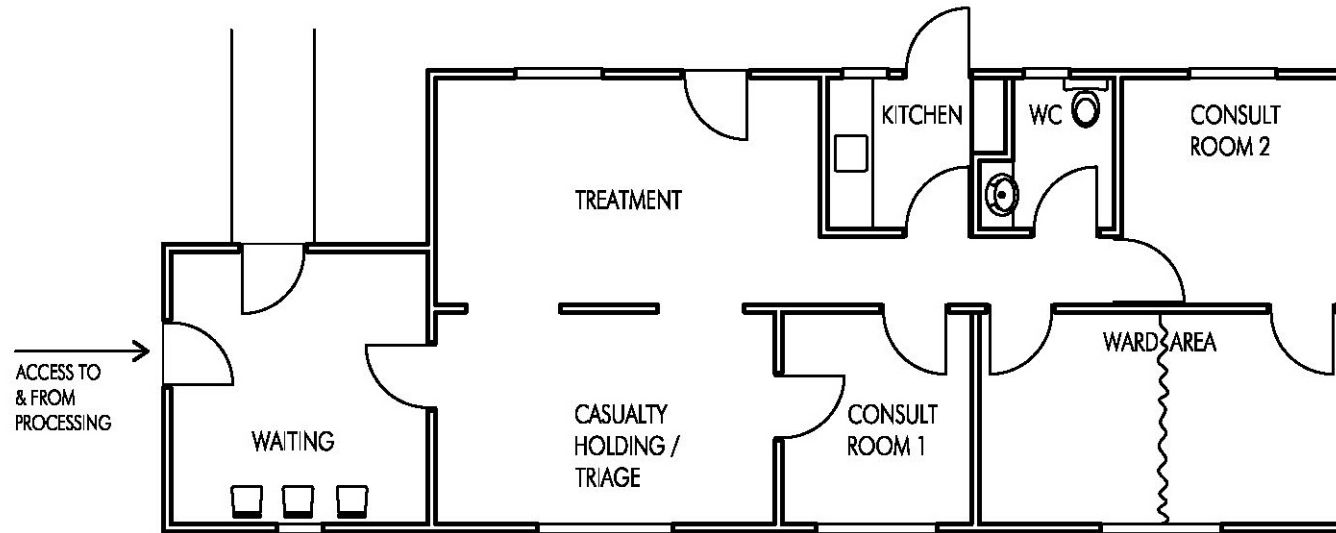

MEDICAL CENTRE
Floor Plan - 1:100



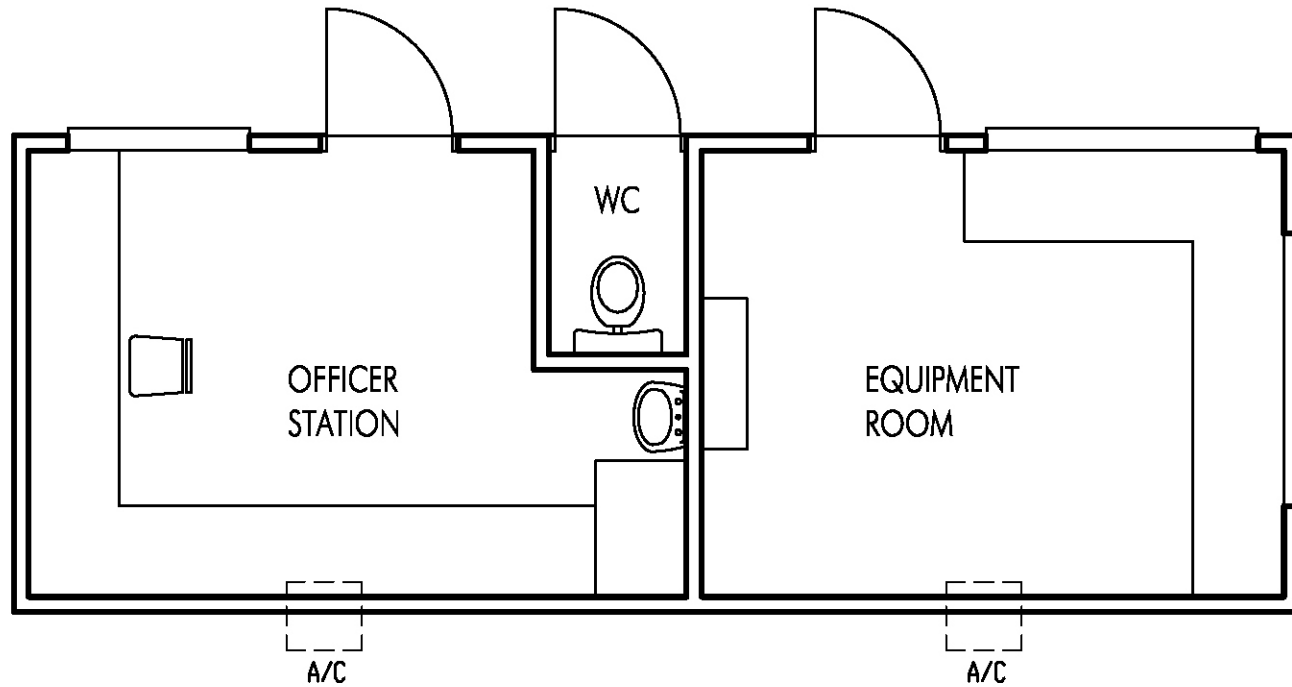

OFFICER STATION (Building No. 2)
Floor Plan - 1:50

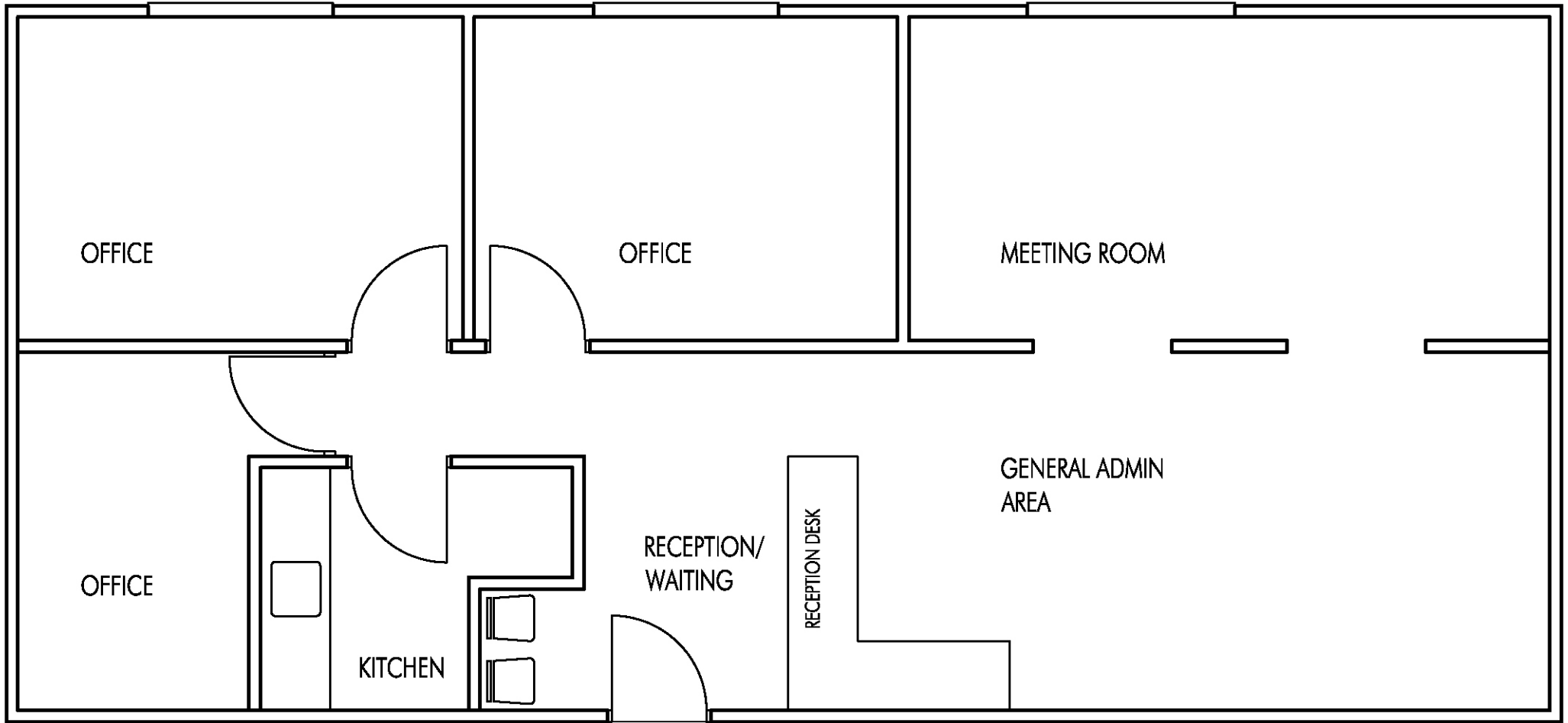

DETENTION SERVICES
Floor Plan - 1:50

VISITS CENTRE
Floor Plan - 1:100

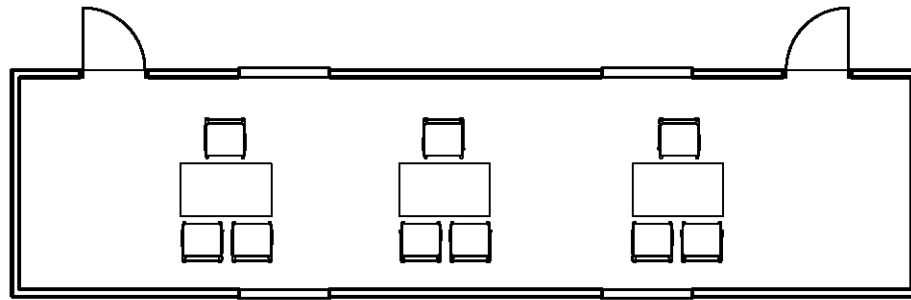

INTERVIEW BUILDING
Floor Plan - 1:100

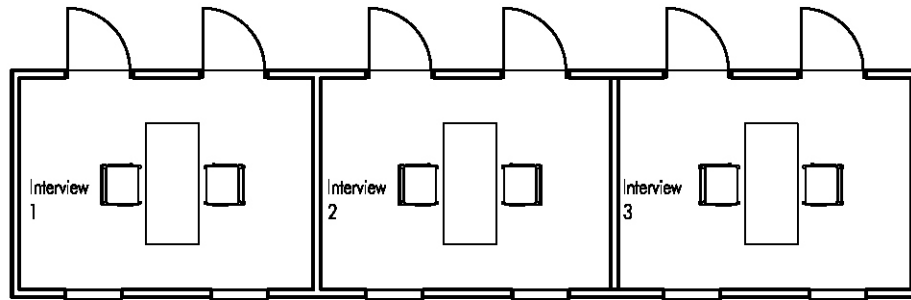

DRY GOODS STORE
Floor Plan - 1:100

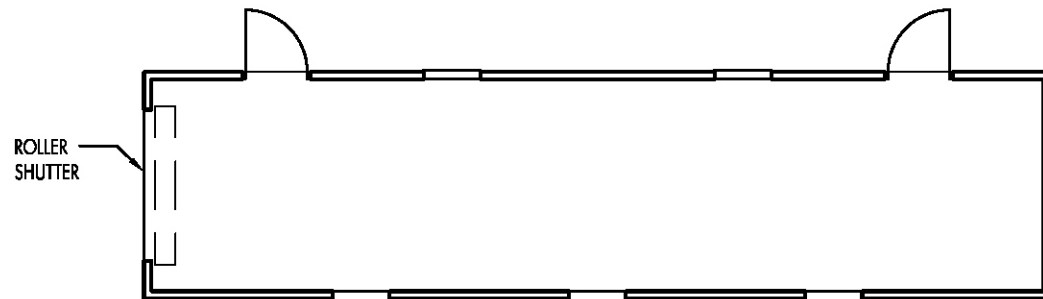

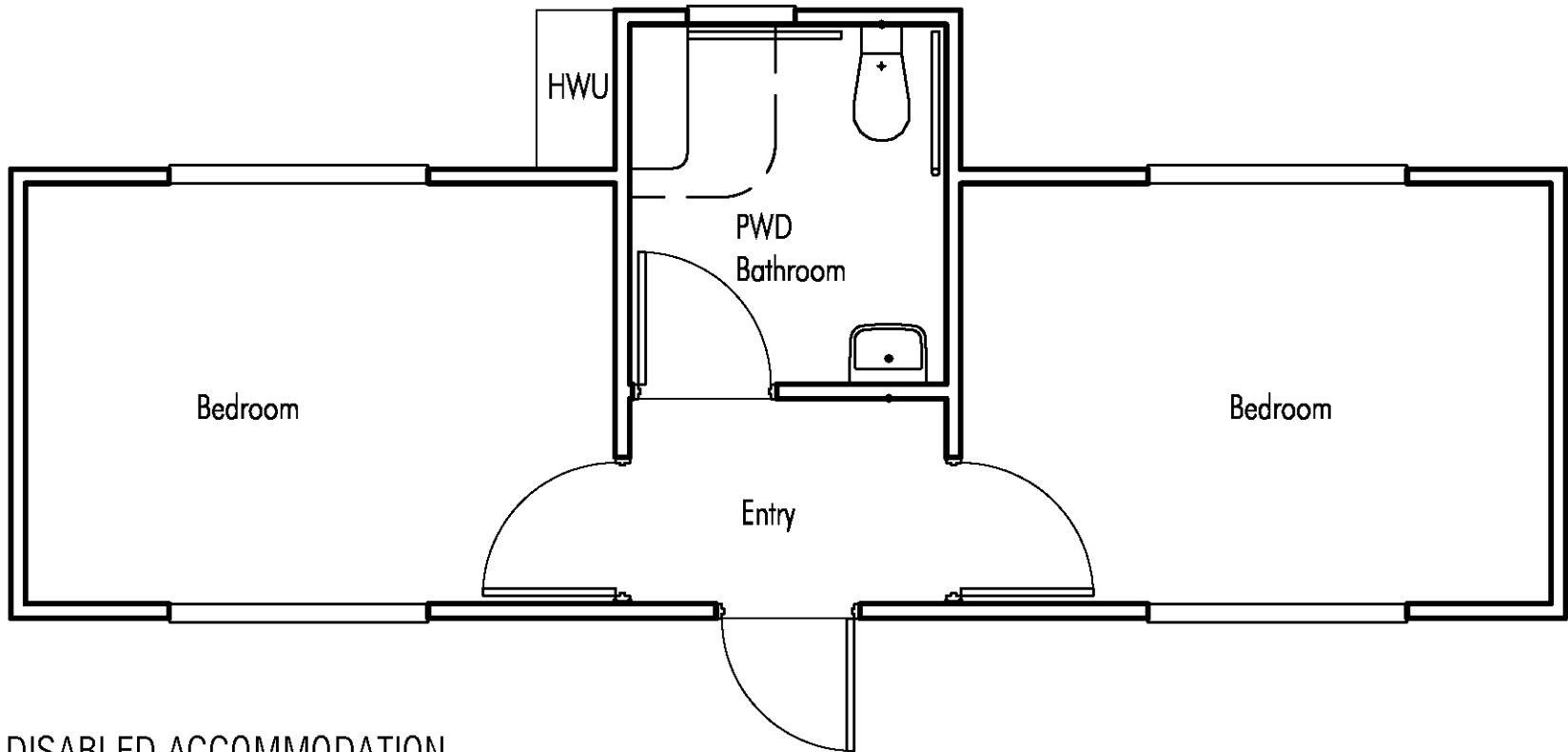

DISABLED ACCOMMODATION
Floor Plan - 1:50



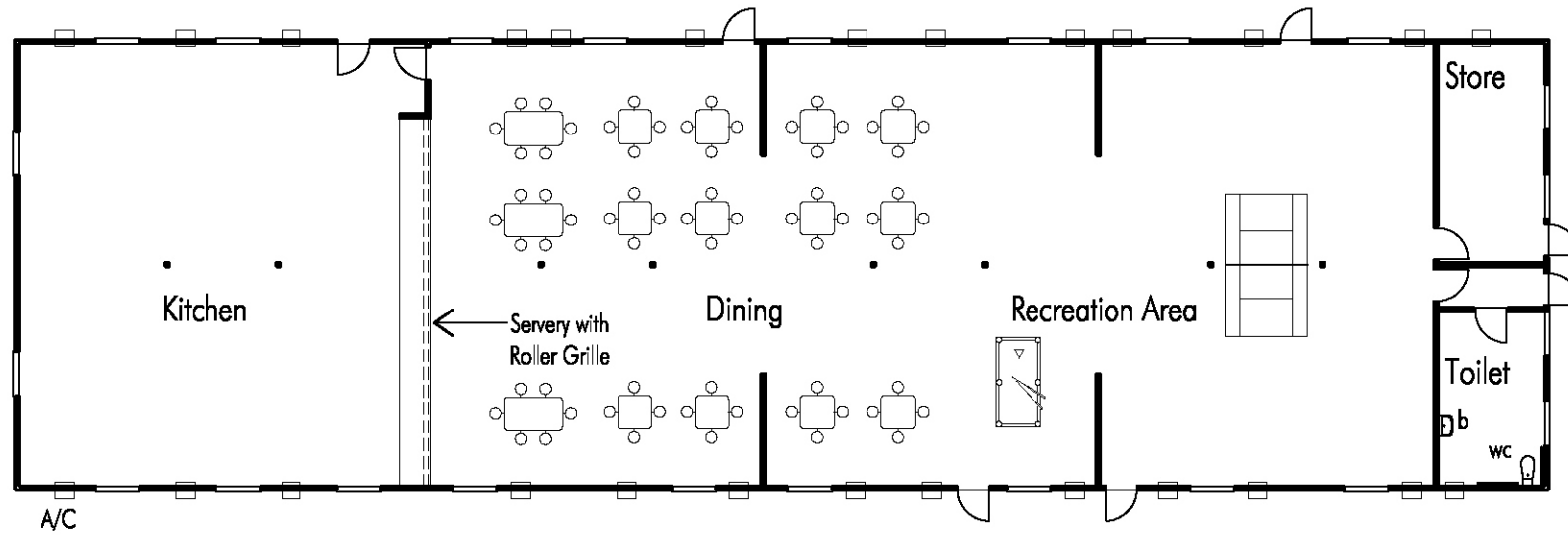

DINING & RECREATION FACILITY
Floor Plan - 1:200



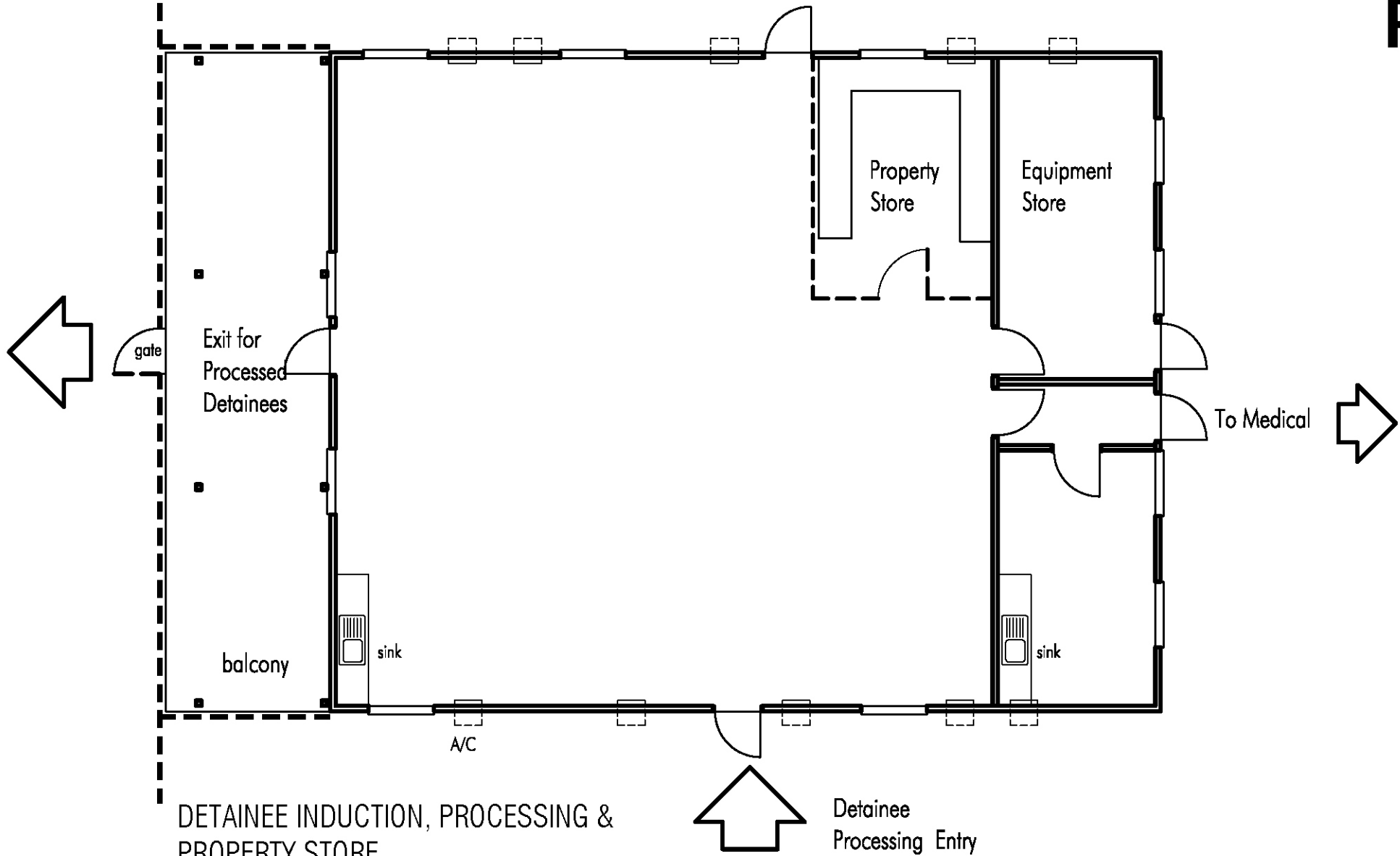

DETAINEE INDUCTION, PROCESSING &
PROPERTY STORE
Floor Plan - 1:100



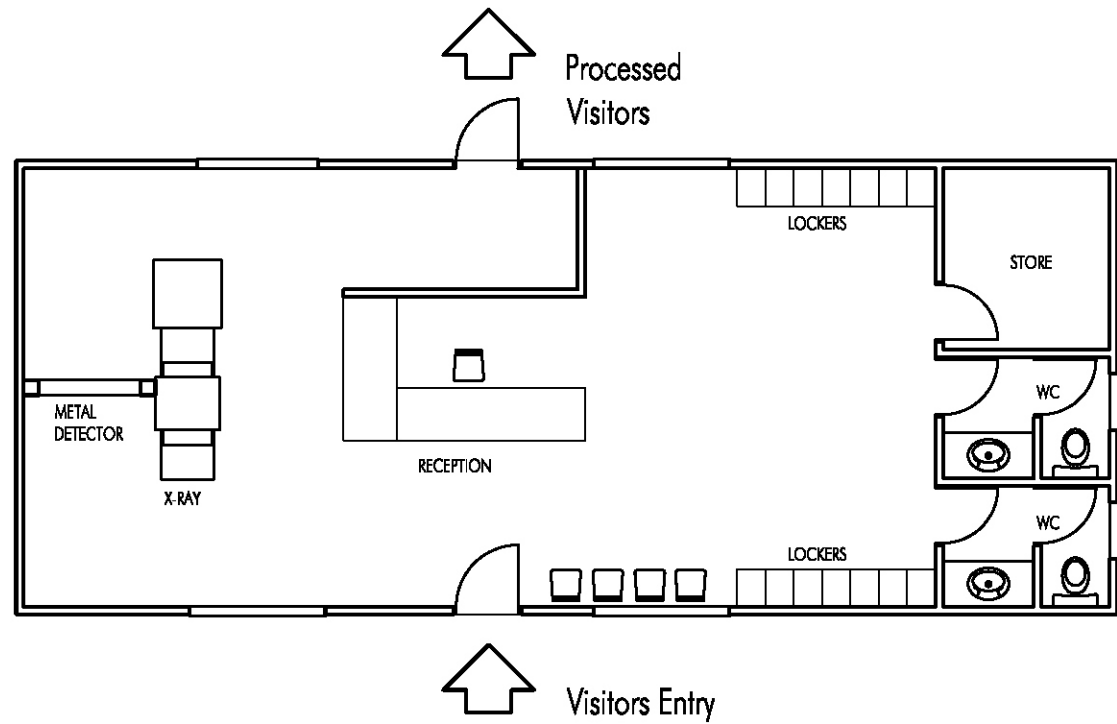

VISITOR RECEPTION PROCESSING & SCREENING
Floor Plan - 1:100

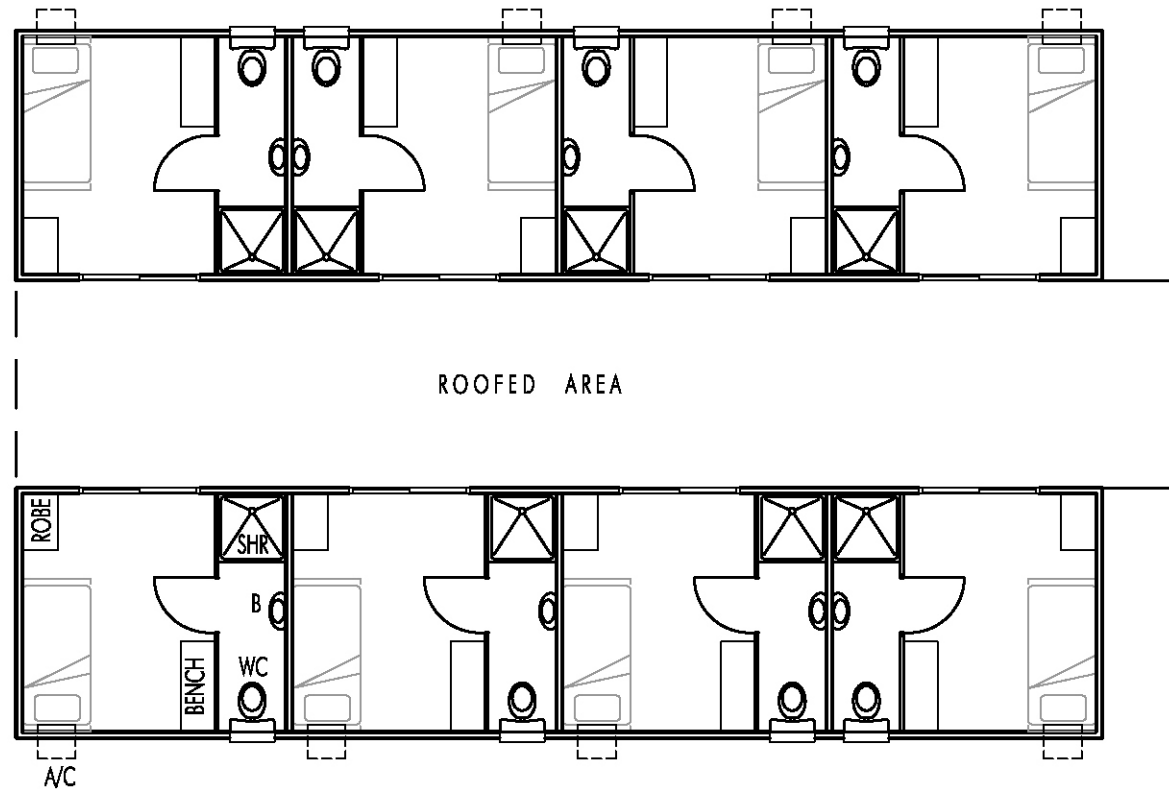

ACCOMMODATION BUILDING

Floor Plan - 1:100

