

1987-88-89

The Parliament of the  
Commonwealth of Australia

Joint Standing Committee  
on the New Parliament House

Report relating to  
proposed work in the Parliamentary Zone

Upgrade and refurbishment of the  
southern entry to the  
Administrative Building, Parkes, ACT

MEMBERSHIP OF THE JOINT STANDING COMMITTEE ON THE  
NEW PARLIAMENT HOUSE

(Thirty-fifth Parliament)

Joint Chairmen

Senator the Hon. K W Sibraa  
President of the Senate

Hon. Leo McLeay, MP  
Speaker of the House of Representatives

Members

Hon. S J West, MP  
Minister for Administrative Services

Senator M E Baume

Senator M A Colston

Senator A R Devlin

Senator D J MacGibbon

Senator M E Reid

Senator C C Schacht

Hon. J D M Dobie, MP

Mr S C Dubois, MP

Mr T A Fischer, MP

Mr M J Lee, MP

Hon. M J R MacKellar, MP

Acting Secretary to the Committee

Ms D Dixon

## PROPOSED WORK IN THE PARLIAMENTARY ZONE

### UPGRADE AND REFURBISHMENT OF THE SOUTHERN ENTRY TO THE ADMINISTRATIVE BUILDING, PARKES, ACT

Under paragraph 4 of its resolution of appointment, the Joint Standing Committee on the New Parliament House is authorised to consider and report on matters coming within the terms of section 5 of the Parliament Act 1974 as may be referred to it by the Minister responsible for administering the National Capital Development Commission Act 1957, or by resolution of either House of the Parliament.

Section 5 of the Parliament Act 1974 gives Parliament control over the erection of buildings or other work within the Parliamentary Zone which is defined in the Act. Subsection 5(1) of the Act provides as follows:

No building or other work is to be erected on land within the Parliamentary zone unless the Minister has caused a proposal for the erection of the building or work to be laid before each House of the Parliament and the proposal has been approved by resolution of each House of Parliament.

#### BACKGROUND

On 6 September 1989 the House of Representatives, on the motion of the Minister for the Arts, Tourism and Territories, referred the following proposal within the Parliamentary zone to this committee for consideration and report:

Upgrade and refurbishment of the southern entry to the Administrative Building, Parkes.

#### THE PROPOSAL

The Department of Administrative Services on behalf of the Department of Foreign Affairs and Trade proposes to upgrade and refurbish the southern entry to the Administrative Building, Parkes.

The work would comprise internal works and the extension of the waiting area to provide a draft lobby. Due to space restrictions this draft lobby cannot be contained within the existing building and would extend into the present forecourt by 5.5 metres.

It is proposed to construct the lobby using curved glazing in natural anodized aluminium framing with stone clad blade wall columns and door archways. This cladding is to match existing cladding.

In order to direct traffic to the entrance, modifications are also proposed to the landscaping in the forecourt.

The estimated cost of the work is \$150 000. It is expected to be commenced in October 1989 and to be completed by the end of the year.

The attached plans show the location and design of the work.

#### CONCLUSION

The Committee accepts the need for this work in the Parliamentary Zone.

#### RECOMMENDATION

The Committee recommends approval of the following work in the Parliamentary Zone:

Upgrade and refurbishment of the southern entry to the Administrative Building, Parkes.

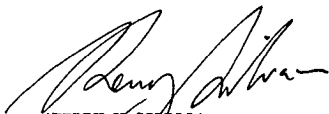

(KERRY W SIIRAA)  
President  
of the Senate



(LEO MCLEAY)  
Speaker of the House  
of Representatives

October 1989

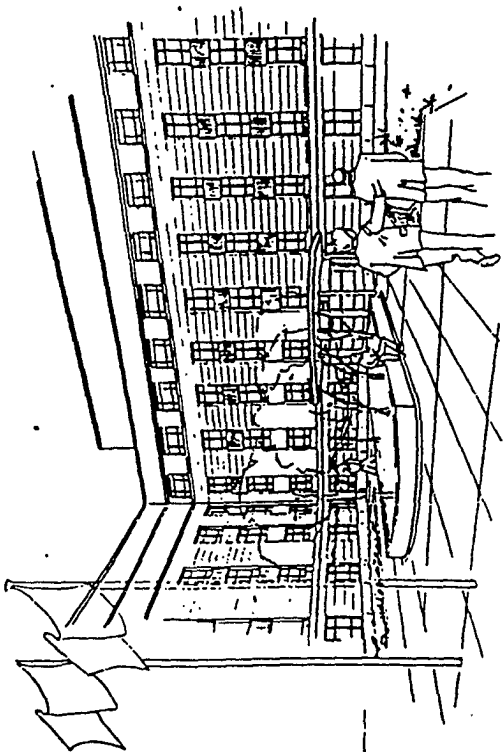

SOUTHERN ENTRY LOBBY  
ADMINISTRATIVE BUILDING



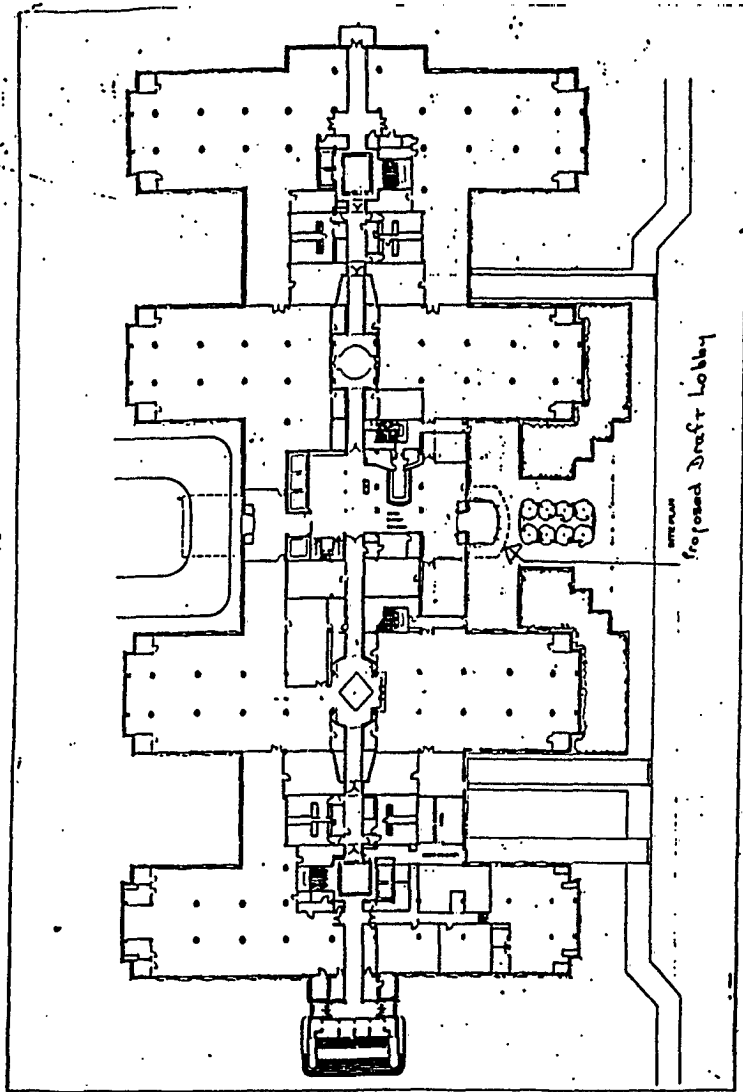

AREA PLAN

Proposed Draft Lobby

SOUTHERN ENTRY LOBBY  
ADMINISTRATIVE BUILDING

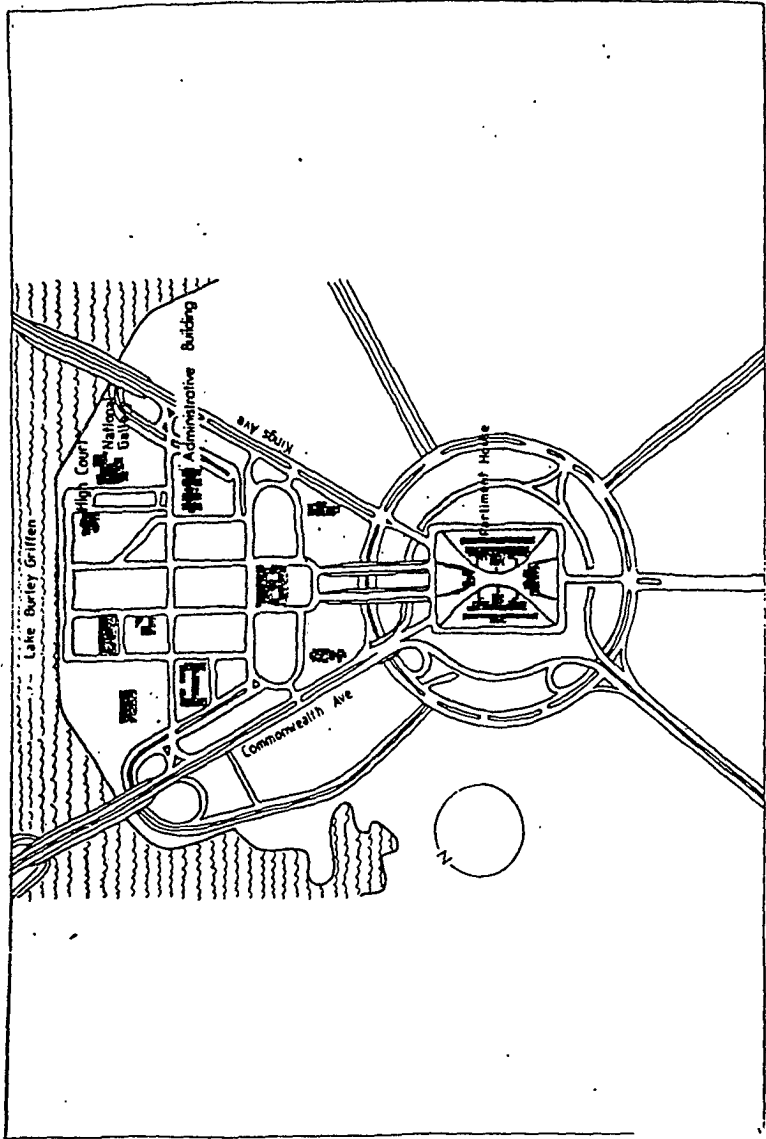

ADMINISTRATIVE BUILDING